

REFERENCE "A"

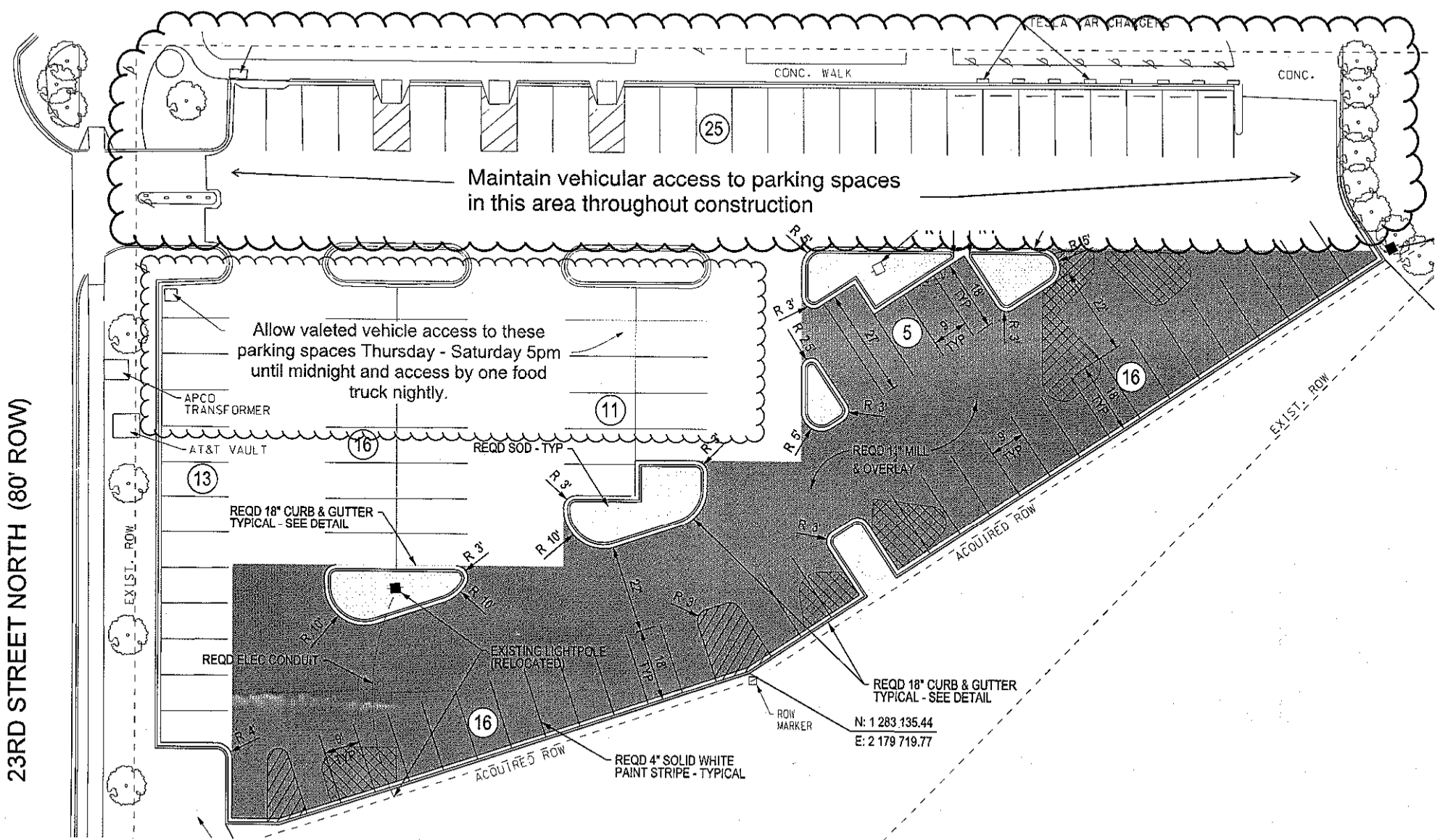

23RD STREET NORTH (80' ROW)

Allow valeted vehicle access to these parking spaces Thursday - Saturday 5pm until midnight and access by one food truck nightly.

Maintain vehicular access to parking spaces in this area throughout construction

APCO TRANSFORMER

AT&T VAULT

REQD 18" CURB & GUTTER TYPICAL - SEE DETAIL

REQD ELEC CONDUIT

EXISTING LIGHTPOLE (RELOCATED)

REQD 18" CURB & GUTTER TYPICAL - SEE DETAIL

N: 1 283 135.44
E: 2 179 719.77

REQD 4" SOLID WHITE PAINT STRIPE - TYPICAL

EXIST. ROW

ACQUIRED ROW

EXIST. ROW

ACQUIRED ROW